

INSTRUMENT PANEL/METER COMPONENTS

710LL-01

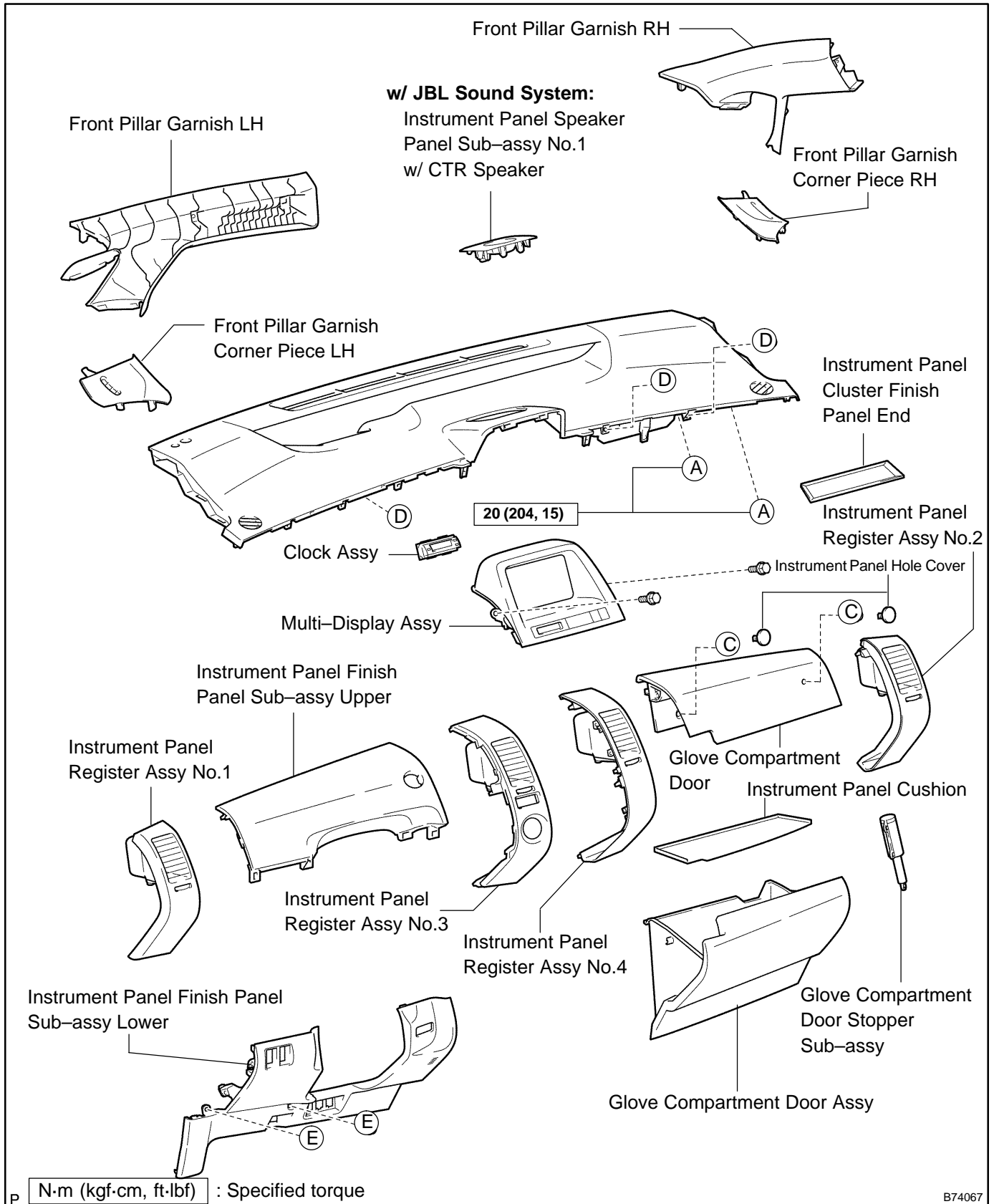

B74067

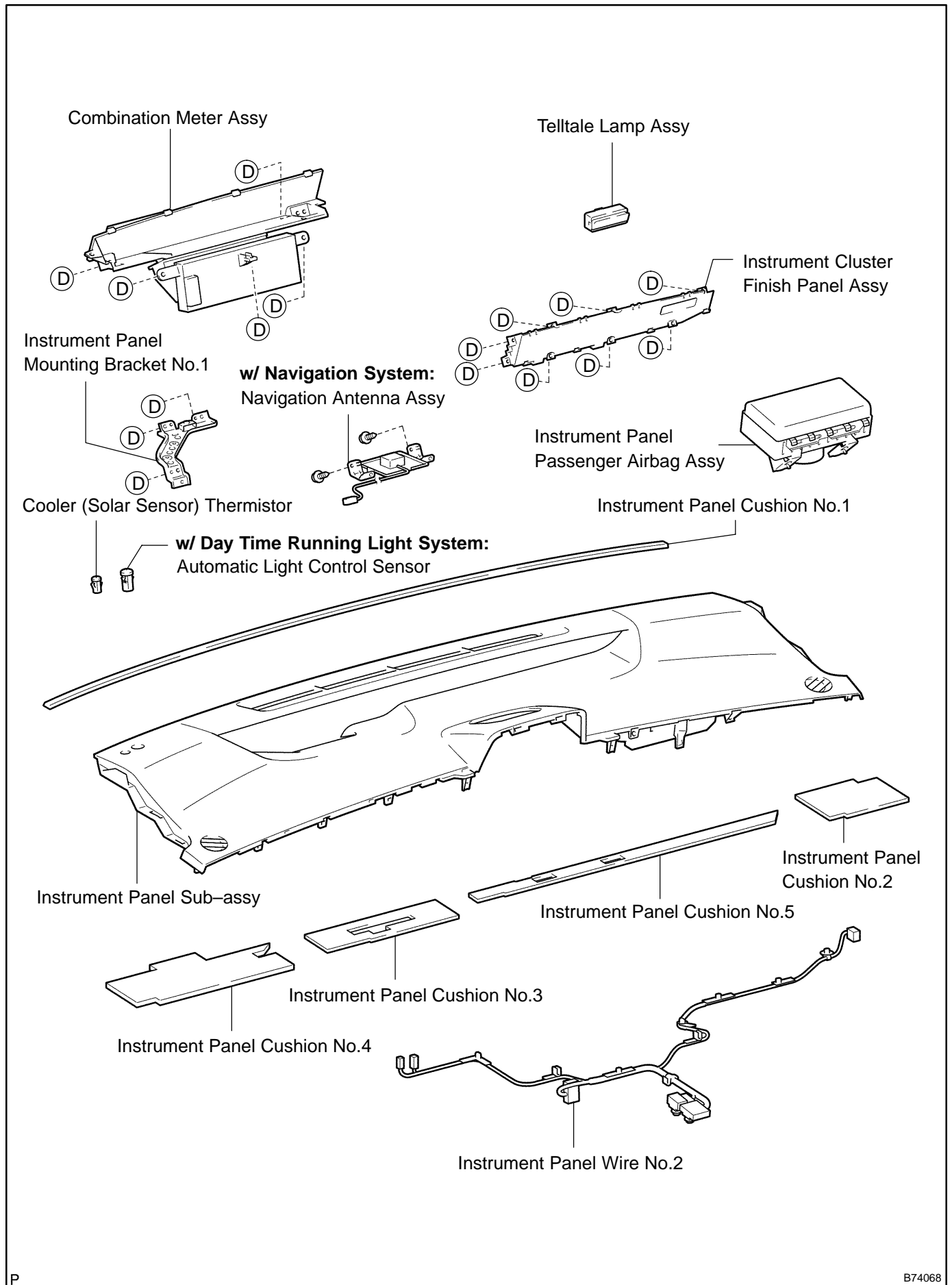

P

B74068

INSTRUMENT PANEL/METER - INSTRUMENT PANEL/METER

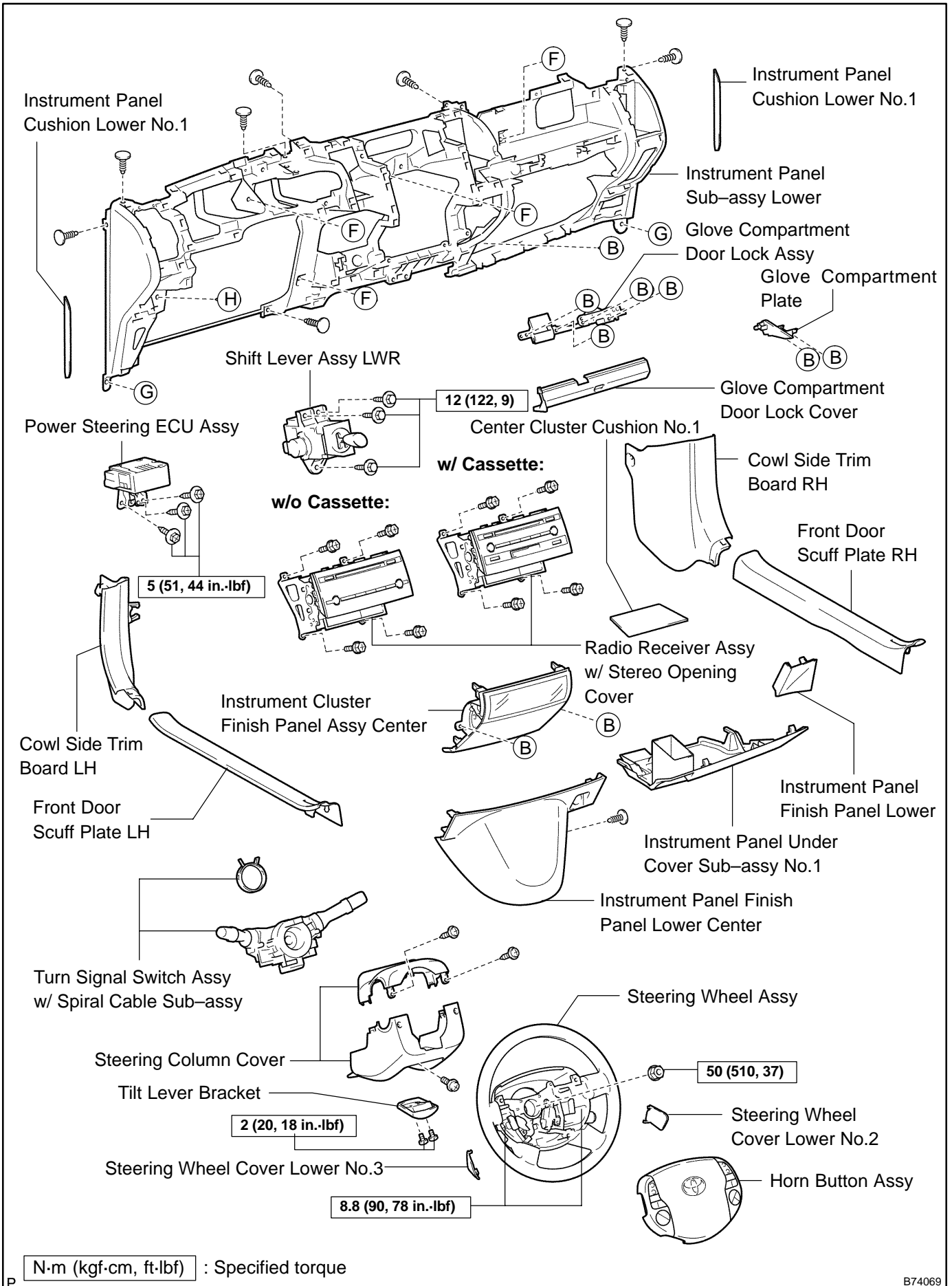

B74069

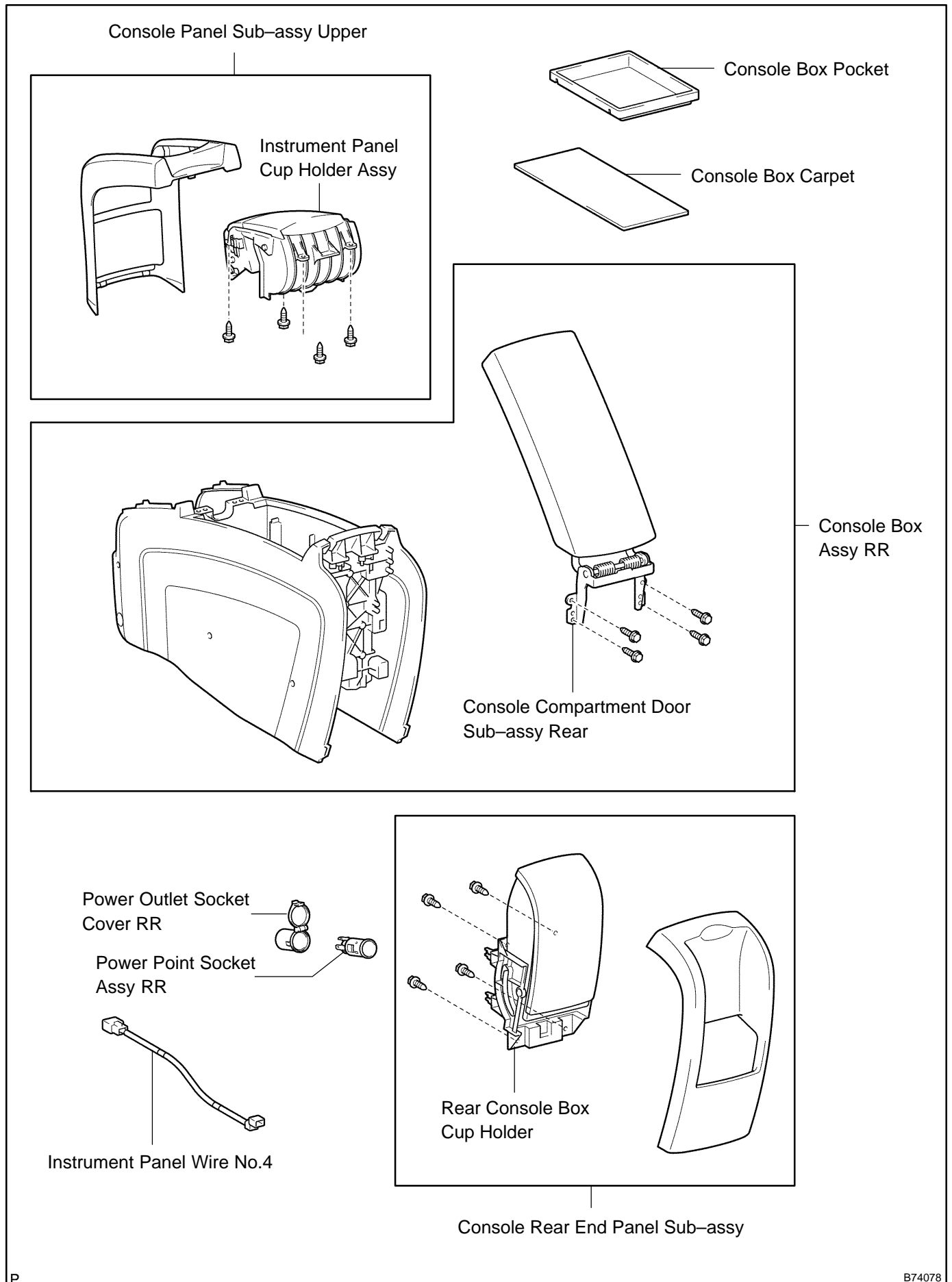

P

B74078

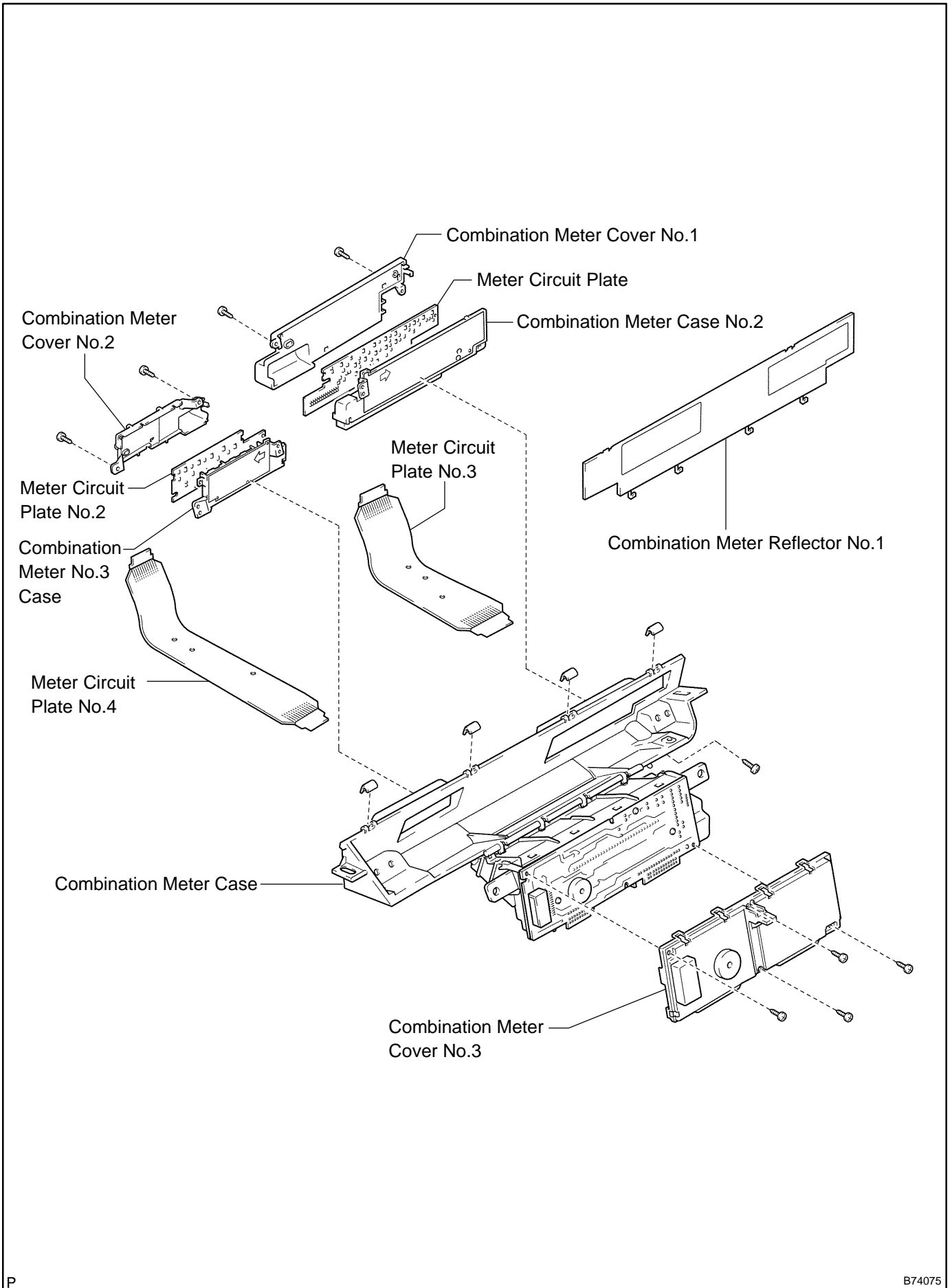

P

B74075

PRECAUTION

1. PRECAUTION FOR VEHICLE WITH SRS AIRBAG AND SEAT BELT PRETENSIONER

- (a) Some operations in this section may affect the SRS airbags. Prior to performing the corresponding operations, read the SRS airbag NOTICE (see page [60-1](#)).

NOTICE FOR INITIALIZATION:

When disconnecting the negative (–) battery terminal, initialize the following systems after the terminal is reconnected.

System Name	See Page
Power Window Control System	01-28

NOTICES FOR HYBRID SYSTEM ACTIVATION:

- **When the warning lamp is illuminated or the battery has been disconnected and reconnected, pressing the power switch may not start the system on the first try. If so, press the power switch again.**
- **With the power switch's power mode changed to ON (IG), disconnect the battery. If the key is not in the key slot during reconnection, DTC B2799 may be output.**

INSTRUMENT PANEL SUB-ASSY REPLACEMENT

710LN-01

HINT:

- Installation is in the reverse order of removal.
- COMPONENTS: SEE PAGE 71-1

1. TABLE OF BOLT, SCREW AND NUT

HINT:

All bolts, screws and nuts relevant to installing and removing the instrument panel are shown along with their alphabet code in the table below.

mm (in.) (L = Length)

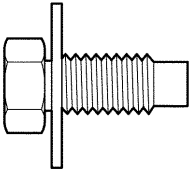
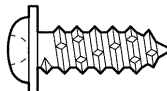
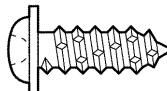
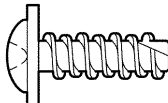
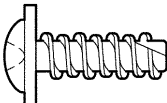
Code	Shape	Code	Shape	Code	Shape
<A>	 φ = 8 (0.31) L = 20 (0.79) 91633-60820		 φ = 5 (0.20) L = 16 (0.63) B30768 93567- 15016	<C>	 φ = 5 (0.20) L = 14 (0.55) B50922 93567- 55014
<D>	 φ = 5 (0.20) L = 14 (0.55) 93568-55014	<E>	 φ = 5 (0.20) L = 18 (0.71) 93568-55018		

P

B74072

2. DISCONNECT BATTERY NEGATIVE TERMINAL (SEE PAGE 60-1)

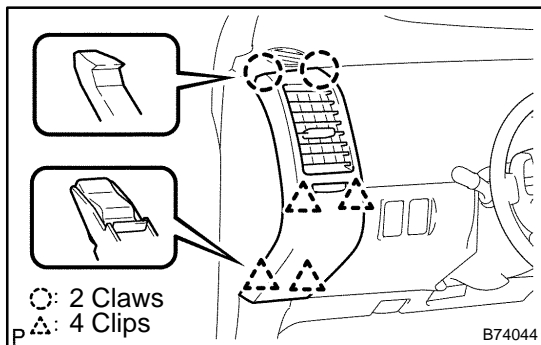

3. REMOVE INSTRUMENT PANEL REGISTER ASSY NO.1

- Disengage the 2 claws and the 4 clips and then remove the instrument panel register assy No.1.

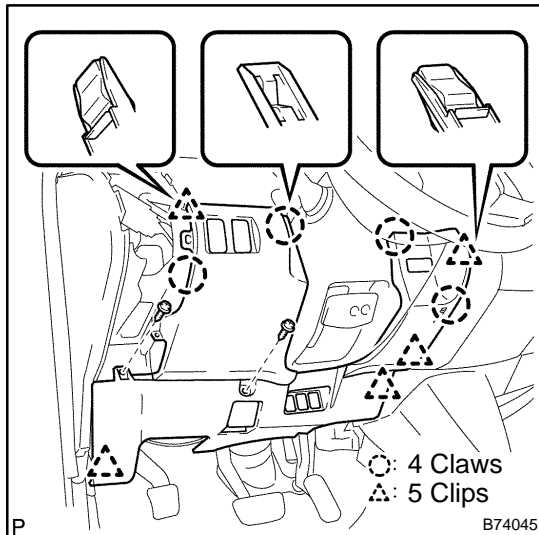

4. REMOVE INSTRUMENT PANEL FINISH PANEL SUB-ASSY LOWER

- Remove the 2 screws <E>.
- Disconnect the hood lock control cable assy.
- Disengage the 4 claws and the 5 clips.
- Disconnect all connectors and then remove the instrument panel finish panel sub-assy lower.

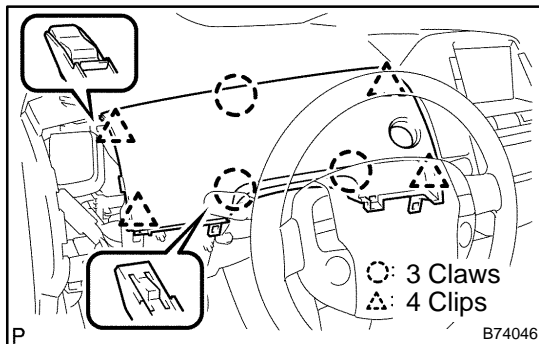

5. REMOVE INSTRUMENT PANEL FINISH PANEL SUB-ASSY UPPER

- Disengage the 3 claws and the 4 clips.
- Disconnect the connector and then remove the instrument panel finish panel sub-assy upper.

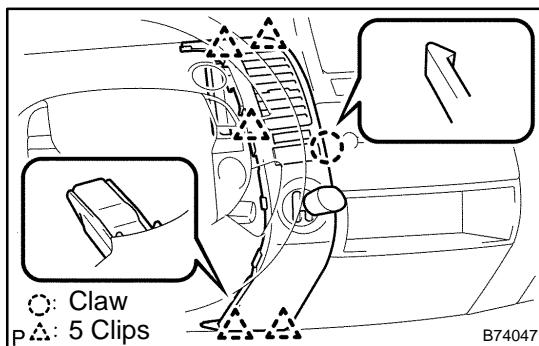

6. REMOVE INSTRUMENT PANEL REGISTER ASSY NO.3

- Disengage the claw and the 5 clips.
- Disconnect the connector and then remove the instrument panel register assy No.3

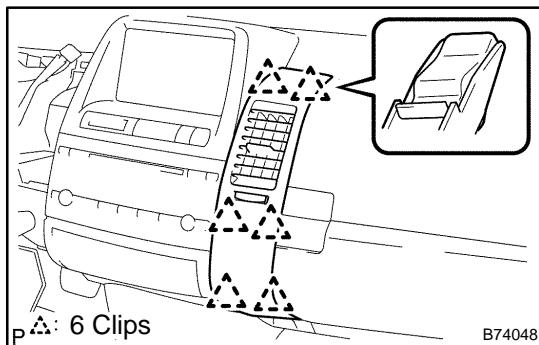

7. REMOVE INSTRUMENT PANEL REGISTER ASSY NO.4

- Disengage the 6 clips and then remove the instrument panel register assy No.4.

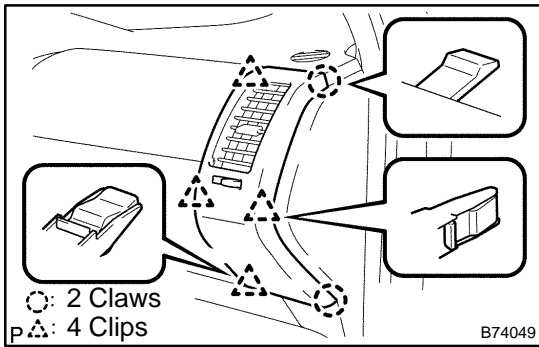

8. REMOVE INSTRUMENT PANEL REGISTER ASSY NO.2

- (a) Disengage the 2 claws and the 4 clips, and then remove the instrument panel register assy No.2.

9. REMOVE MULTI-DISPLAY ASSY (SEE PAGE 67-7)

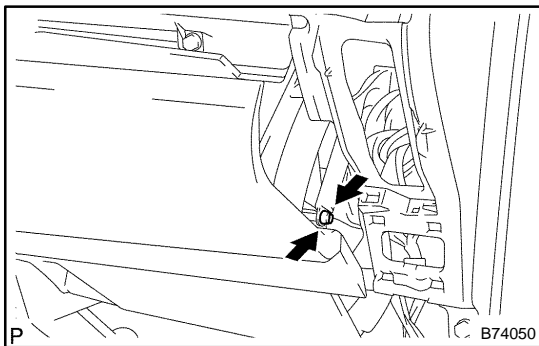

10. REMOVE GLOVE COMPARTMENT DOOR STOPPER SUB-ASSY

- (a) Holding the part indicated in the illustration, remove the glove compartment door stopper sub-assy from the glove compartment door assy.

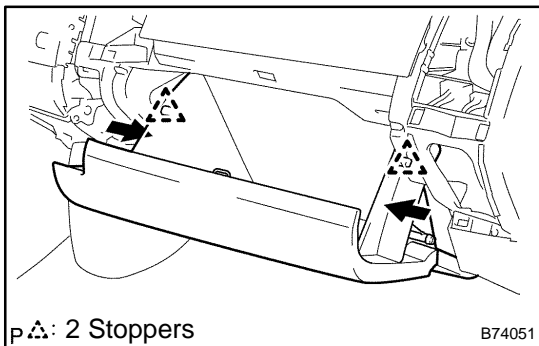

11. REMOVE GLOVE COMPARTMENT DOOR ASSY

- (a) Push in at the locations indicated by arrows in the illustration and remove the stoppers.

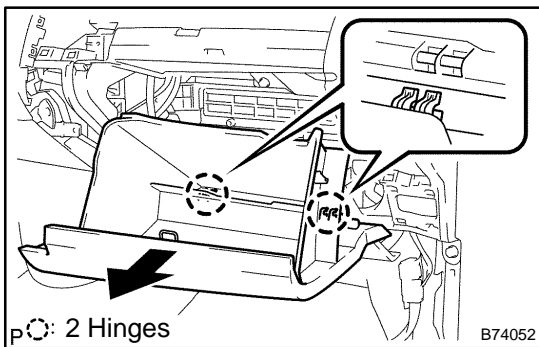

- (b) Pull in the direction indicated by the arrow in the illustration and disengage the 2 hinges. Remove the glove compartment door assy.

- 12. REMOVE INSTRUMENT PANEL CUSHION**
- 13. REMOVE INSTRUMENT CLUSTER FINISH PANEL END**
- 14. REMOVE INSTRUMENT PANEL HOLE COVER**

- (a) Using a screwdriver, remove the 2 instrument panel hole covers.

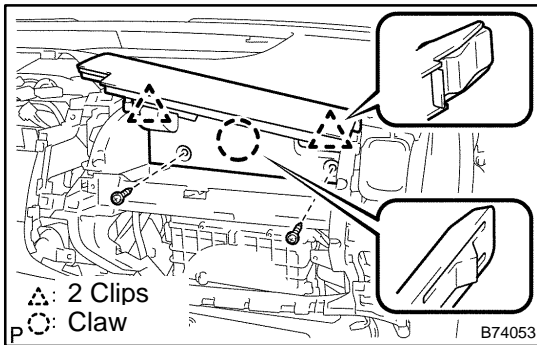
**15. REMOVE GLOVE COMPARTMENT DOOR**

- (a) Remove the 2 screws <C>.
- (b) Disengage the claw and the 2 clips, and then remove the glove compartment door.

16. REMOVE INSTR PANEL SPEAKER PANEL SUB-ASSY NO.1 W/CTR SPEAKER (W/ JBL SOUND SYSTEM) (SEE PAGE 67-11)**17. REMOVE FRONT PILLAR GARNISH CORNER PIECE LH (SEE PAGE 76-28)****18. REMOVE FRONT PILLAR GARNISH CORNER PIECE RH (SEE PAGE 76-28)****19. REMOVE FRONT PILLAR GARNISH LH (SEE PAGE 76-28)****20. REMOVE FRONT PILLAR GARNISH RH (SEE PAGE 76-28)****21. DISCONNECT PASSENGER AIRBAG CONNECTOR (SEE PAGE 60-32)****22. REMOVE INSTRUMENT PANEL SUB-ASSY W/PASSENGER AIRBAG ASSY**

- (a) Remove the 3 screws <D>.
- (b) Remove the 2 bolts <A>.
- (c) Pulling up the instrument panel, disengage the 6 claws and the 3 clips.
- (d) Remove the instrument panel and passenger airbag as a single unit, being careful not to damage the steering wheel assy.

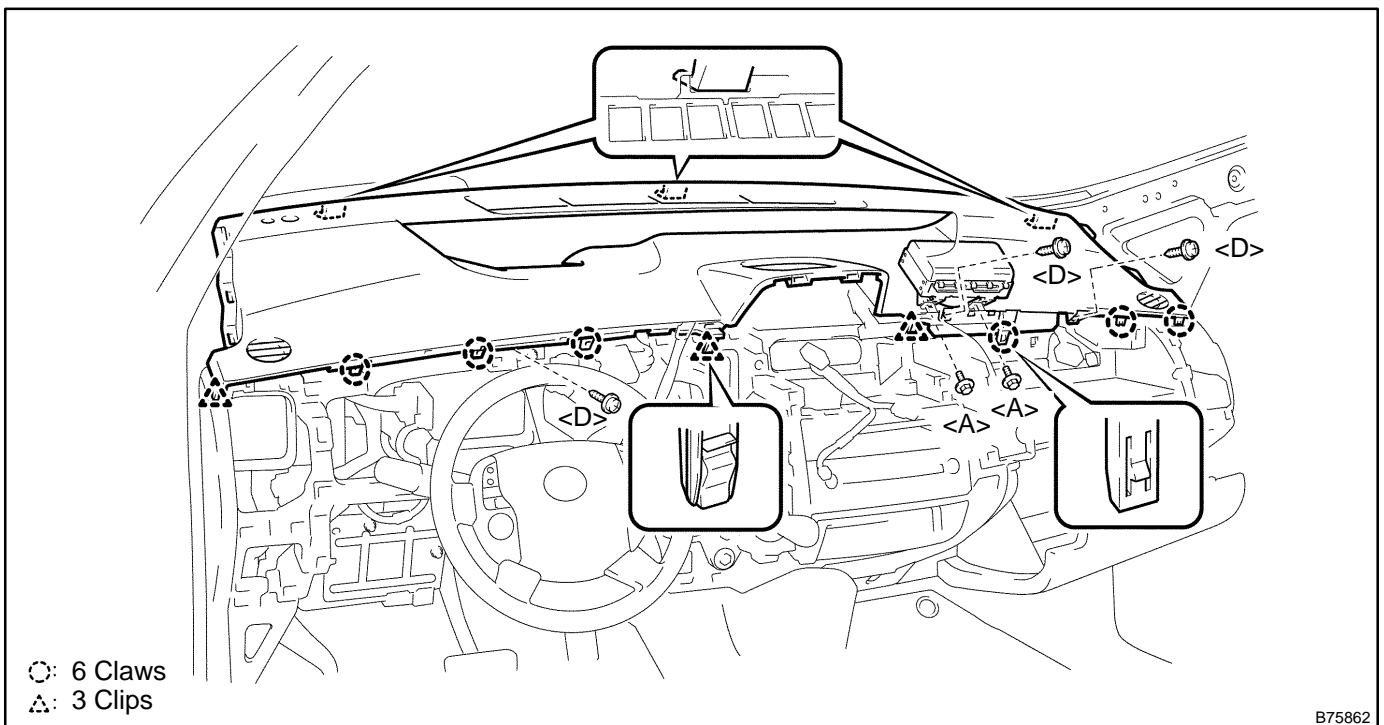

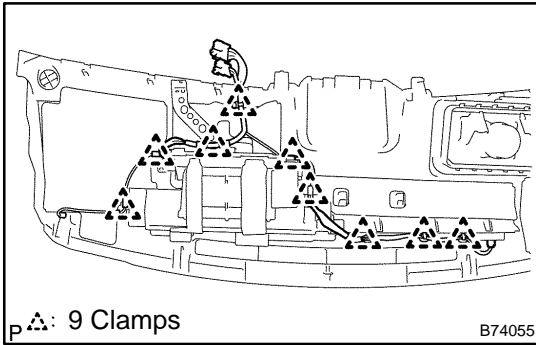
**23. REMOVE INSTRUMENT PANEL WIRE NO.2**

- (a) Disengage the 9 clamps and then remove the instrument panel wire No.2.

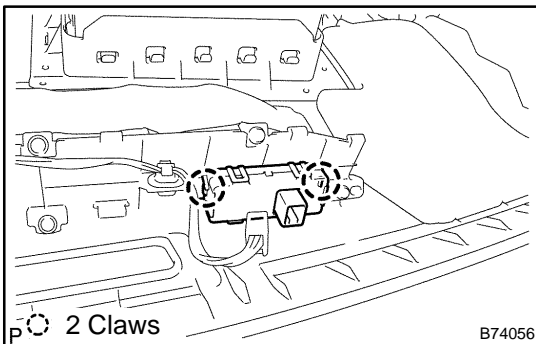
24. REMOVE COOLER (SOLAR SENSOR) THERMISTOR**25. REMOVE AUTOMATIC LIGHT CONTROL SENSOR (W/ DAY TIME RUNNING LIGHT SYSTEM)****26. REMOVE TELLTALE LAMP ASSY**

- (a) Disengage the 2 claws and then remove the telltale lamp assy.

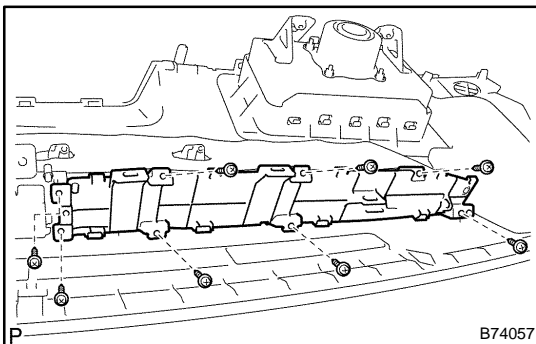
**27. REMOVE INSTRUMENT CLUSTER FINISH PANEL ASSY**

- (a) Remove the 8 screws <D> and then the instrument cluster finish panel assy.

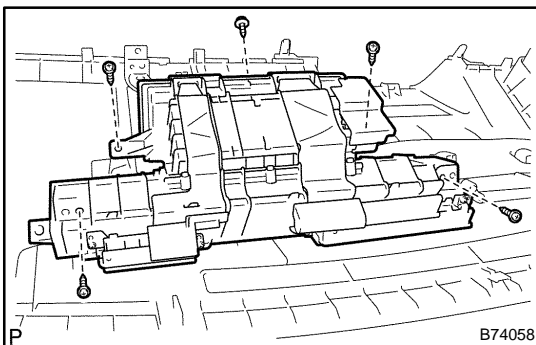
**28. REMOVE COMBINATION METER ASSY**

- (a) Remove the 5 screws <D> and then the combination meter assy.

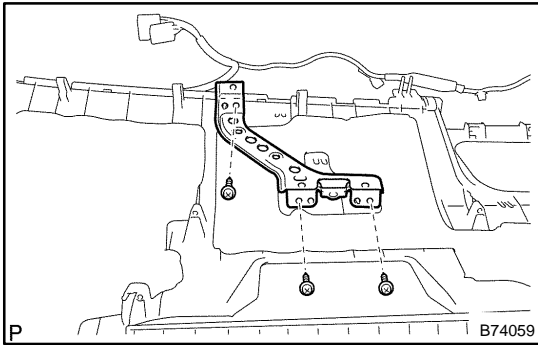

29. REMOVE INSTRUMENT PANEL MOUNTING BRACKET NO.1

- (a) Remove the 3 screws <D> and then the instrument panel mounting bracket No.1.

30. REMOVE NAVIGATION ANTENNA ASSY (W/ NAVIGATION SYSTEM) (SEE PAGE 67-22)

31. REMOVE INSTR PNL PASS L/DOOR AIR BAG ASSY (SEE PAGE 60-32)

32. REMOVE INSTRUMENT PANEL CUSHION NO.1

33. REMOVE INSTRUMENT PANEL CUSHION NO.2

34. REMOVE INSTRUMENT PANEL CUSHION NO.3

35. REMOVE INSTRUMENT PANEL CUSHION NO.4

36. REMOVE INSTRUMENT PANEL CUSHION NO.5

37. REMOVE INSTRUMENT PANEL SUB-ASSY

38. INSTALL INSTRUMENT PANEL SUB-ASSY W/PASSENGER AIRBAG ASSY

- (a) Securely fit the forward-facing instrument panel claws to the body.

- (b) Install the 3 screws <D>.

- (c) Install the 2 passenger airbag fastening bolts <A>.

Torque: 20 N·m (204 kgf·cm, 15 ft·lbf)

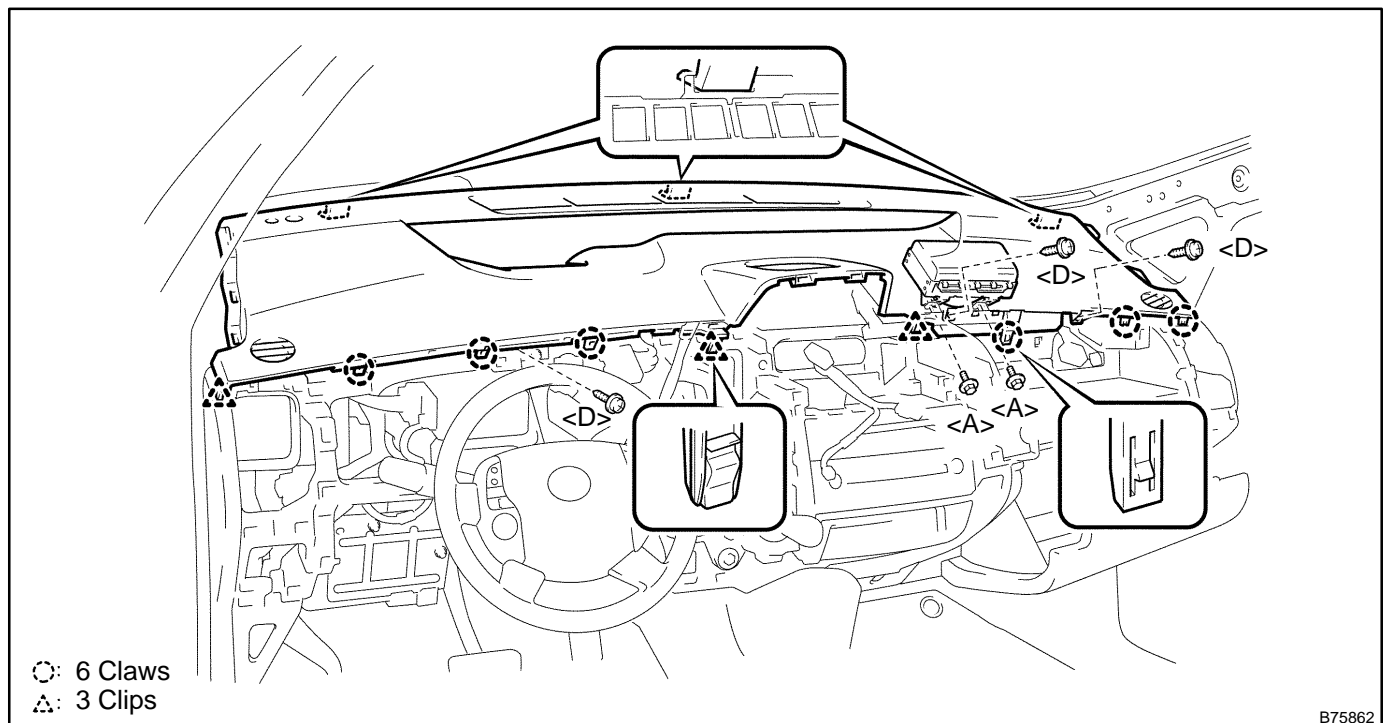

39. CONNECT BATTERY NEGATIVE TERMINAL (SEE PAGE 19-2)

40. INSPECT SRS WARNING LIGHT (SEE PAGE 05-1397)

41. PERFORM INITIALIZATION (SEE PAGE 01-28)

INSTRUMENT PANEL SUB-ASSY LOWER REPLACEMENT

710LO-01

HINT:

- Installation is in the reverse order of removal.
- COMPONENTS: SEE PAGE 71-1

1. TABLE OF BOLT, SCREW AND NUT

HINT:

All bolts, screws and nuts relevant to installing and removing the instrument panel are shown along with their alphabet code in the table below.

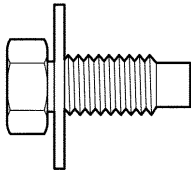
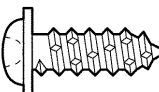
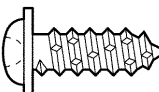
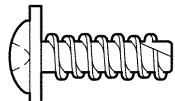
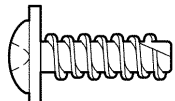
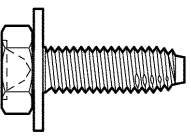
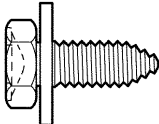
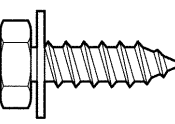
mm (in.) (L = Length)					
Code	Shape	Code	Shape	Code	Shape
<A>	 $\phi = 8$ (0.31) L = 20 (0.79) 91633-60820		 $\phi = 5$ (0.20) L = 16 (0.63) B30768 93567-15016	<C>	 $\phi = 5$ (0.20) L = 14 (0.55) B50922 93567-55014
<D>	 $\phi = 5$ (0.20) L = 14 (0.55) 93568-55014	<E>	 $\phi = 5$ (0.20) L = 18 (0.71) 93568-55018	<F>	 $\phi = 6$ (0.24) L = 20 (0.79) 90159-60610
<G>	 $\phi = 6$ (0.24) L = 16 (0.63) 91635-60616	<H>	 $\phi = 6$ (0.24) L = 20 (0.79) 90159-60200		

P

B74073

- DISCONNECT BATTERY NEGATIVE TERMINAL (SEE PAGE 60-1)
- REMOVE INSTRUMENT PANEL SUB-ASSY W/PASSENGER AIRBAG ASSY (SEE PAGE 71-7)
- REMOVE STEERING WHEEL COVER LOWER NO.2
- REMOVE STEERING WHEEL COVER LOWER NO.3
- REMOVE HORN BUTTON ASSY (SEE PAGE 60-20)
- REMOVE STEERING WHEEL ASSY (SEE PAGE 50-8)
SST 09950-50013 (09951-05010, 09952-05010, 09953-05020, 09954-05021)
- REMOVE TILT LEVER BRACKET (SEE PAGE 50-8)
- REMOVE STEERING COLUMN COVER (SEE PAGE 50-8)
- REMOVE TURN SIGNAL SWITCH ASSY W/SPIRAL CABLE SUB-ASSY (SEE PAGE 50-8)
- REMOVE FRONT DOOR SCUFF PLATE LH (SEE PAGE 76-28)
- REMOVE FRONT DOOR SCUFF PLATE RH (SEE PAGE 76-28)
- REMOVE COWL SIDE TRIM BOARD LH (SEE PAGE 76-28)
- REMOVE COWL SIDE TRIM BOARD RH (SEE PAGE 76-28)

2004 Prius - Preliminary Release (RM1075U)

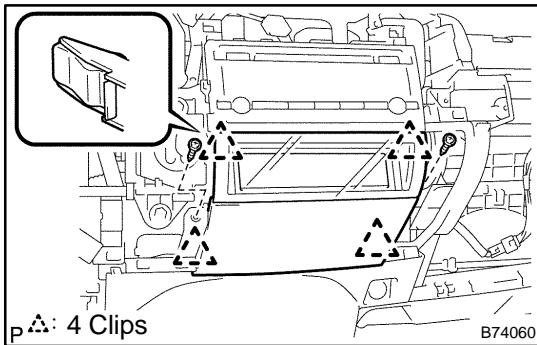

15. REMOVE INSTRUMENT CLUSTER FINISH PANEL ASSY CENTER

- (a) Remove the 2 screws .
- (b) Disengage the 4 clips and then remove the instrument cluster finish panel assy center.

16. REMOVE CENTER CLUSTER CUSHION NO.1

17. REMOVE RADIO RECEIVER ASSY W/STEREO OPENING COVER (SEE PAGE 67-5)

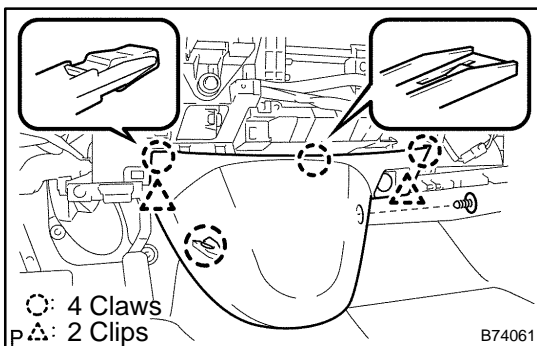

18. REMOVE INSTRUMENT PANEL FINISH PANEL LOWER CENTER

- (a) Using a clip remover, remove the clip from the instrument panel finish panel lower center.
- (b) Disengage the 4 claws and the 2 clips, and then remove the instrument panel finish panel lower center.

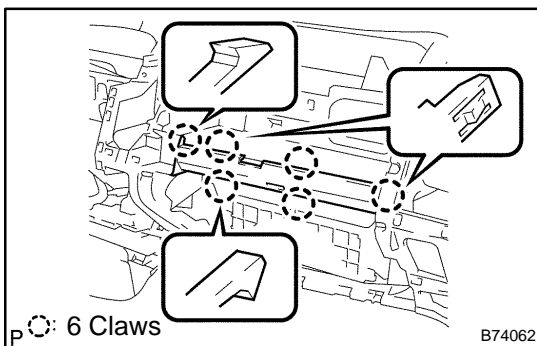

19. REMOVE GLOVE COMPARTMENT DOOR LOCK COVER

- (a) Disengage the 6 claws and then remove the glove compartment door lock cover.

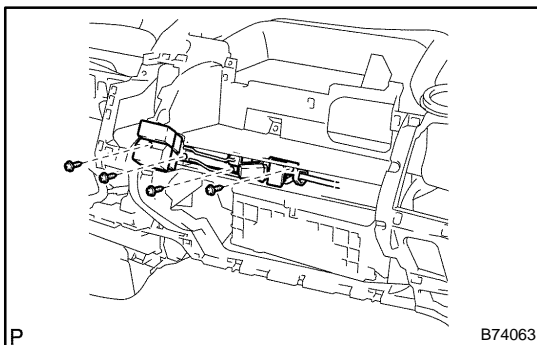

20. REMOVE GLOVE COMPARTMENT DOOR LOCK ASSY

- (a) Remove the 4 screws and then the glove compartment door lock assy.

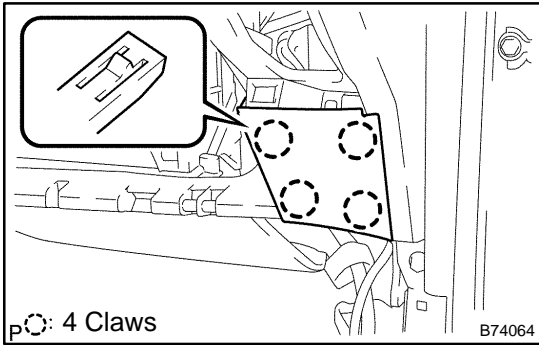

21. REMOVE INSTRUMENT PANEL FINISH PANEL LOWER

- (a) Disengage the 4 claws and then remove the instrument panel finish panel lower.

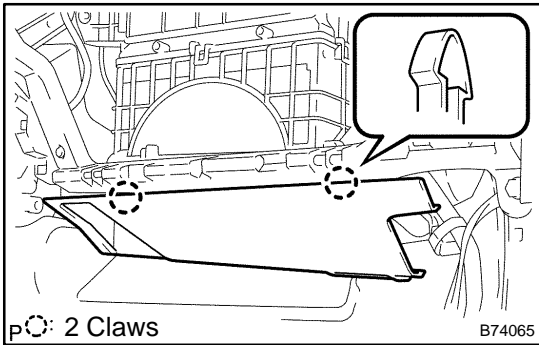

22. REMOVE INSTRUMENT PANEL UNDER COVER SUB-ASSY NO.1

- (a) Disengage the 2 claws and then remove the instrument panel under cover sub-assy No.1.

23. REMOVE POWER STEERING ECU ASSY (SEE PAGE 50-16)

24. REMOVE SHIFT LEVER ASSY LWR (SEE PAGE 22-69)

25. REMOVE INSTRUMENT PANEL SUB-ASSY LOWER

- (a) Using a clip remover, remove the 8 clips from the duct and the instrument panel sub-assy lower.
- (b) Remove the 4 bolts <F>, and the 2 bolts <G>.
- (c) Remove the screw , and the screw <H>.
- (d) Disconnect all connectors, and disengage all clamps. Make sure the wire harness is not caught on anything, and then remove the instrument panel sub-assy lower.

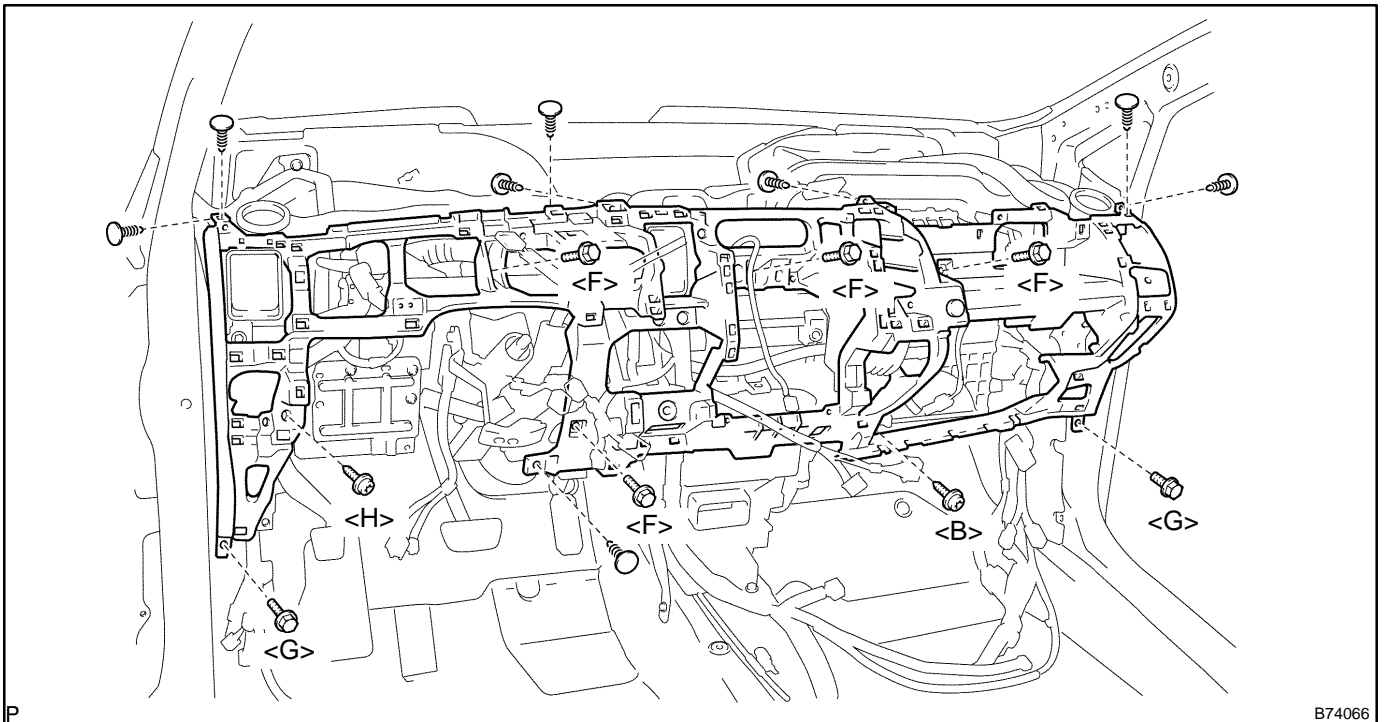

26. **REMOVE GLOVE COMPARTMENT PLATE**
 - (a) Remove the 2 screws .
 - (b) Disengage the 2 claws and then remove the glove compartment plate.
27. **REMOVE INSTRUMENT PANEL CUSHION LOWER NO.1**
28. **INSTALL SHIFT LEVER ASSY LWR (SEE PAGE 22-69)**
29. **INSTALL POWER STEERING ECU ASSY (SEE PAGE 50-16)**
30. **INSTALL INSTRUMENT PANEL SUB-ASSY W/PASSENGER AIRBAG ASSY (SEE PAGE 71-7)**
31. **INSTALL TILT LEVER BRACKET (SEE PAGE 50-8)**
32. **ADJUST SPIRAL CABLE SUB-ASSY (SEE PAGE 60-29)**
33. **INSTALL STEERING WHEEL ASSY (SEE PAGE 50-8)**
34. **INSTALL HORN BUTTON ASSY (SEE PAGE 60-20)**
35. **CONNECT BATTERY NEGATIVE TERMINAL (SEE PAGE 19-2)**
36. **INSPECT HORN BUTTON ASSY (SEE PAGE 60-14)**
37. **INSPECT SRS WARNING LIGHT (SEE PAGE 05-1397)**
38. **PERFORM INITIALIZATION (SEE PAGE 01-28)**
39. **PERFORM CALIBRATION OF TORQUE SENSOR ZERO POINT (SEE PAGE 05-1211)**

CONSOLE BOX SUB-ASSY REAR REPLACEMENT

710LP-01

HINT:

- Installation is in the reverse order of removal.
- COMPONENTS: SEE PAGE 71-1

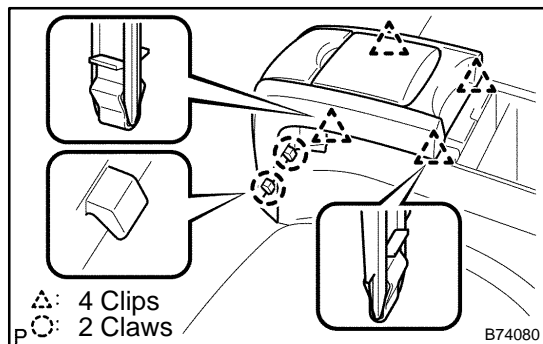

1. REMOVE CONSOLE PANEL SUB-ASSY UPPER

- Pull the console panel sub-assy upper upwards and then disengage the 2 claws.
- Disengage the 4 clips and then remove the console panel sub-assy upper.

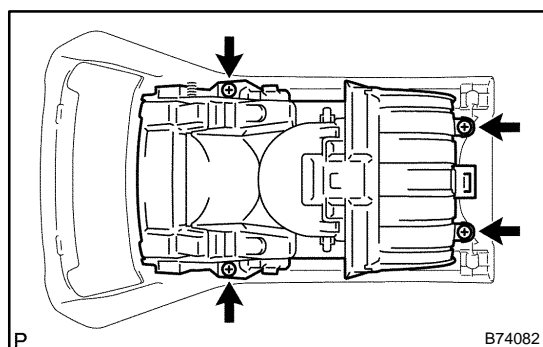

- (1) Remove the 4 screws and then the installment panel cup holder.

2. REMOVE CONSOLE BOX POCKET

3. REMOVE CONSOLE BOX CARPET

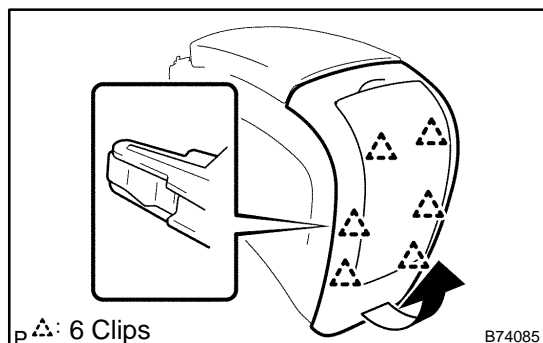

4. REMOVE CONSOLE REAR END PANEL SUB-ASSY

- Pull up the console rear end panel sub-assy in the direction indicated by the arrow to disengage the 6 clips, and remove.

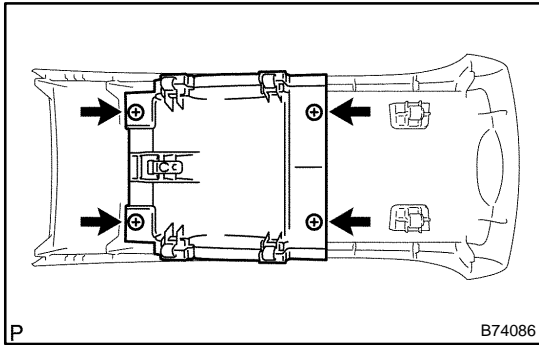

- (1) Remove the 4 screws and then the rear console box cup holder.

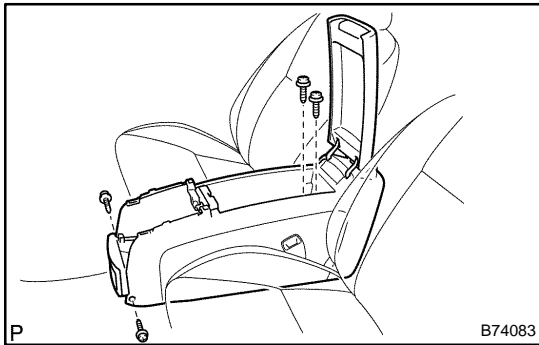

5. REMOVE CONSOLE BOX ASSY RR

- (a) Remove the 2 screws, the 2 bolts, and then the console box assy RR.

6. REMOVE INSTRUMENT PANEL WIRE NO.4

7. REMOVE POWER POINT SOCKET ASSY RR (SEE PAGE 67-31)

8. REMOVE POWER OUTLET SOCKET COVER RR

9. REMOVE CONSOLE COMPARTMENT DOOR SUB-ASSY REAR

HINT:

While the console compartment door sub-assy rear is part of the console box RR, it may be replaced on its own. Refer to the procedure below when removing.

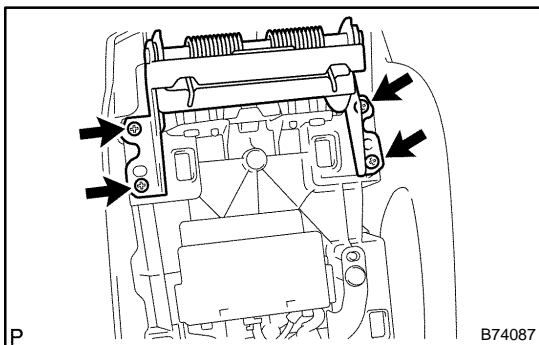

- (a) Remove the 4 screws and then the console compartment door sub-assy rear.

NOTICE:

If the screws are removed while the door is closed, the hinge spring may cause the screws to fly out. Because of this, be sure to remove the screws while the door is open.

COMBINATION METER ASSY OVERHAUL

710LQ-01

NOTICE:

When disassembling the combination meter assy, eliminate static electricity by touching the vehicle body to prevent the components from being damaged.

HINT:

- Installation is in the reverse order of removal.
 - COMPONENTS: SEE PAGE 71-1
1. REMOVE INSTRUMENT PANEL SUB-ASSY W/PASSENGER AIRBAG ASSY
(SEE PAGE 71-7)

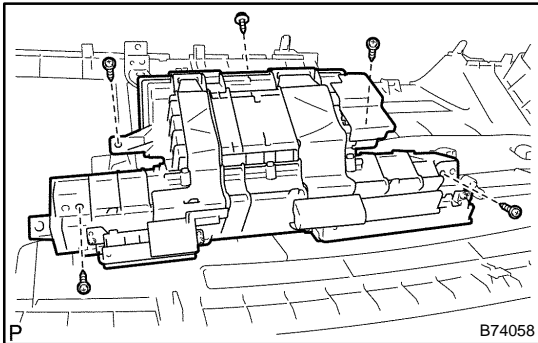

2. REMOVE COMBINATION METER ASSY

- (a) Remove the 5 screws and then the combination meter assy.

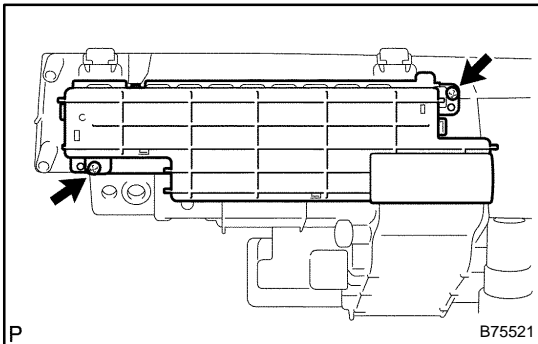

3. REMOVE COMBINATION METER COVER NO.1

- (a) Remove the 2 screws.

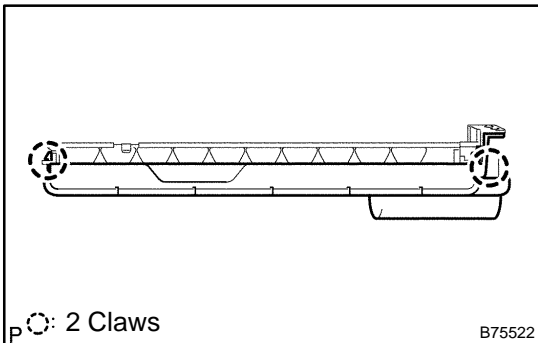

- (b) Disengage the 2 claws and then remove the combination meter cover No.1.

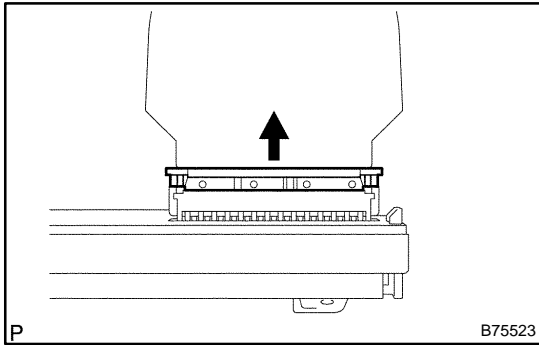

4. REMOVE METER CIRCUIT PLATE

NOTICE:

When disassembling the combination meter assy, eliminate static electricity by touching the vehicle body to prevent the components from being damaged.

- (a) Pull the connector lock in the direction indicated by the arrow in the illustration and separate the meter circuit plate No.3 from the meter circuit plate.

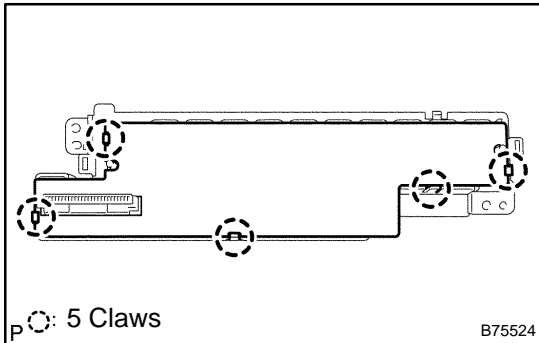

- (b) Disengage the 5 claws and then remove the meter circuit plate.

5. REMOVE COMBINATION METER CASE NO.2

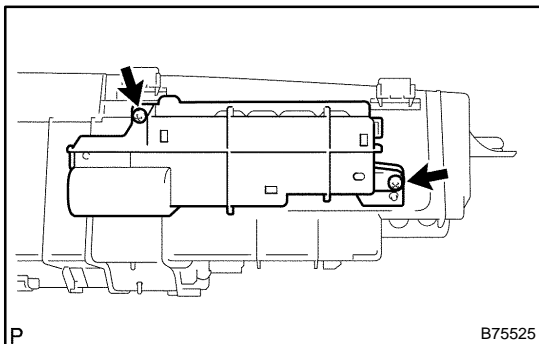

6. REMOVE COMBINATION METER COVER NO.2

NOTICE:

When disassembling the combination meter assy, eliminate static electricity by touching the vehicle body to prevent the components from being damaged.

- (a) Remove the 2 screws.

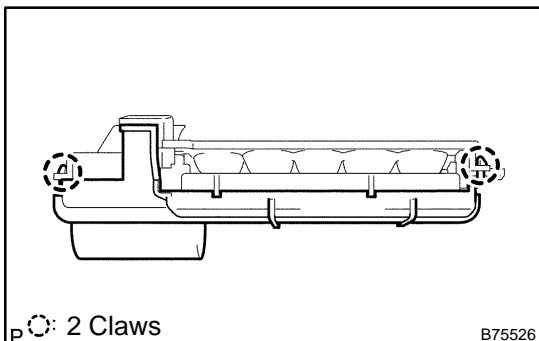

- (b) Disengage the 2 claws and then remove the combination meter cover No.2.

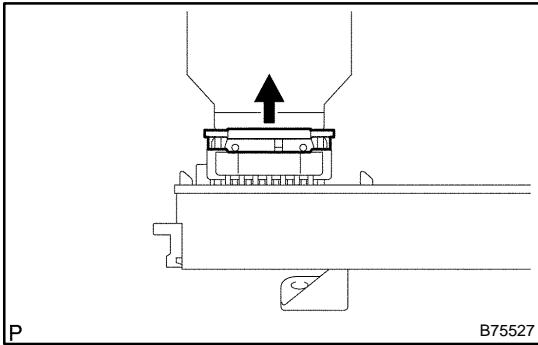

7. REMOVE METER CIRCUIT PLATE NO.2

NOTICE:

When disassembling the combination meter assy, eliminate static electricity by touching the vehicle body to prevent the components from being damaged.

- (a) Pull the connector lock in the direction indicated by the arrow in the illustration and separate the meter circuit plate No.4 from the meter circuit plate No.2.

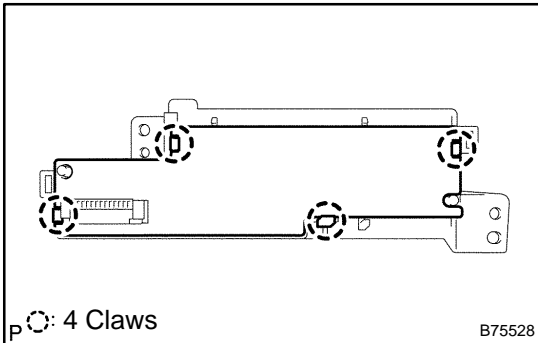

- (b) Disengage the 4 claws, and then remove the meter circuit plate No.2.

8. REMOVE COMBINATION METER NO.3 CASE

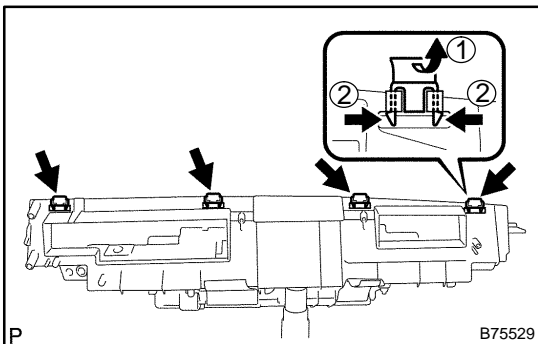

9. REMOVE COMBINATION METER REFLECTOR NO.1

- (a) Remove the 4 clips.

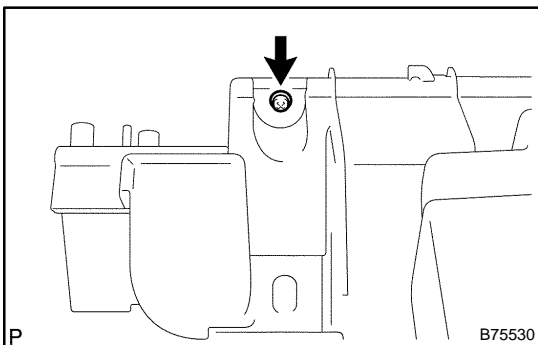

- (b) Remove the screw and then the combination meter reflector No.1.

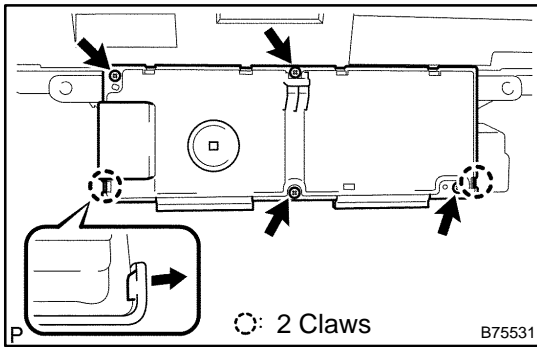
**10. REMOVE COMBINATION METER COVER NO.3**

- (a) Remove the 4 screws.
- (b) Widen the 2 claws along the outside to disengage them.
- (c) Raise the cover from the bottom and remove the combination meter reflector No.1.

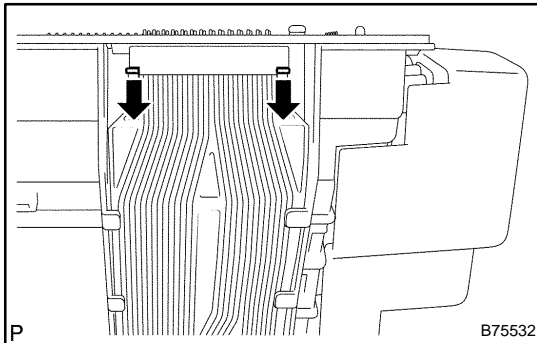
**11. REMOVE METER CIRCUIT PLATE NO.3****NOTICE:**

When disassembling the combination meter assy, eliminate static electricity by touching the vehicle body to prevent the components from being damaged.

- (a) Pull the connector lock in the direction indicated by the arrow in the illustration, and remove the meter circuit plate No.3.

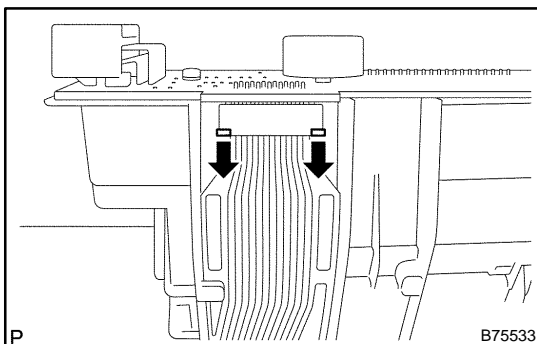
**12. REMOVE METER CIRCUIT PLATE NO.4****NOTICE:**

When disassembling the combination meter assy, eliminate static electricity by touching the vehicle body to prevent the components from being damaged.

- (a) Pull the connector lock in the direction indicated by the arrow in the illustration, and remove the meter circuit plate No.4.

13. REMOVE COMBINATION METER CASE**14. INSTALL INSTRUMENT PANEL SUB-ASSY W/PASSENGER AIRBAG ASSY
(SEE PAGE 71-7)**

TELLTALE LAMP ASSY REPLACEMENT

710LR-01

HINT:

- Installation is in the reverse order of removal.
 - COMPONENTS: SEE PAGE 71-1
- 1. REMOVE INSTRUMENT PANEL SUB-ASSY W/PASSENGER AIRBAG ASSY
(SEE PAGE 71-7)**

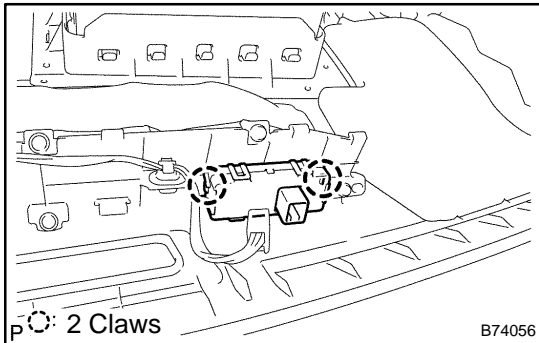
**2. REMOVE TELLTALE LAMP ASSY**

- (a) Disconnect the connector.
- (b) Disengage the 2 claws and then remove the telltale lamp assy.

- 3. INSTALL INSTRUMENT PANEL SUB-ASSY W/PASSENGER AIRBAG ASSY
(SEE PAGE 71-7)**

CLOCK ASSY REPLACEMENT

710LS-01

HINT:

- Installation is in the reverse order of removal.
 - COMPONENTS: SEE PAGE 71-1
1. REMOVE INSTRUMENT PANEL REGISTER ASSY NO.1 (SEE PAGE 71-7)
 2. REMOVE INSTRUMENT PANEL FINISH PANEL SUB-ASSY LOWER (SEE PAGE 71-7)
 3. REMOVE INSTRUMENT PANEL FINISH PANEL SUB-ASSY UPPER (SEE PAGE 71-7)
 4. REMOVE INSTRUMENT PANEL REGISTER ASSY NO.3 (SEE PAGE 71-7)
 5. REMOVE INSTRUMENT PANEL REGISTER ASSY NO.4 (SEE PAGE 71-7)
 6. REMOVE MULTI-DISPLAY ASSY (SEE PAGE 67-7)

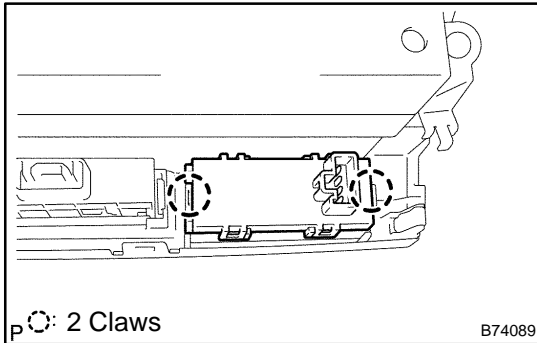
**7. REMOVE CLOCK ASSY**

- (a) Disengage the 2 claws and then remove the clock assy.